



SIXTH FORM OPENING EVENING SCHEDULE

8 November 2023

6.00pm—Admissions talk

Main Atrium

Mr D Rainey (Principal)

Mrs S Barlow (Director of Sixth Form)

Ben Hartigan (Head Boy)

Mitul Edger (External Applicant)

Stephen Preston (EPQ)

From 6.30 pm subject presentations in classrooms

(please see map for location)

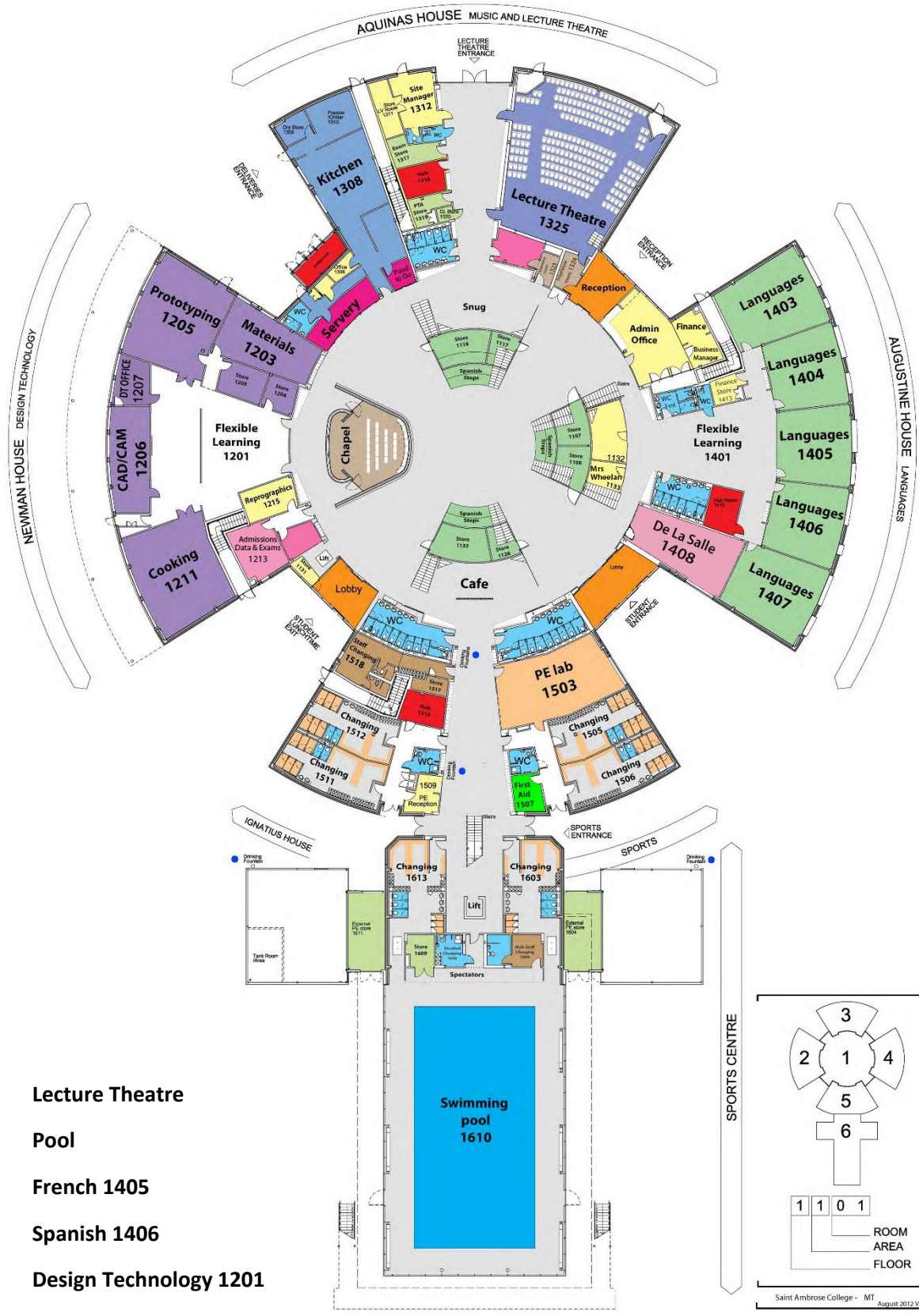

- Lecture Theatre
- Pool
- French 1405
- Spanish 1406
- Design Technology 1201
- Chapel
- PE 1403

Ground Floor

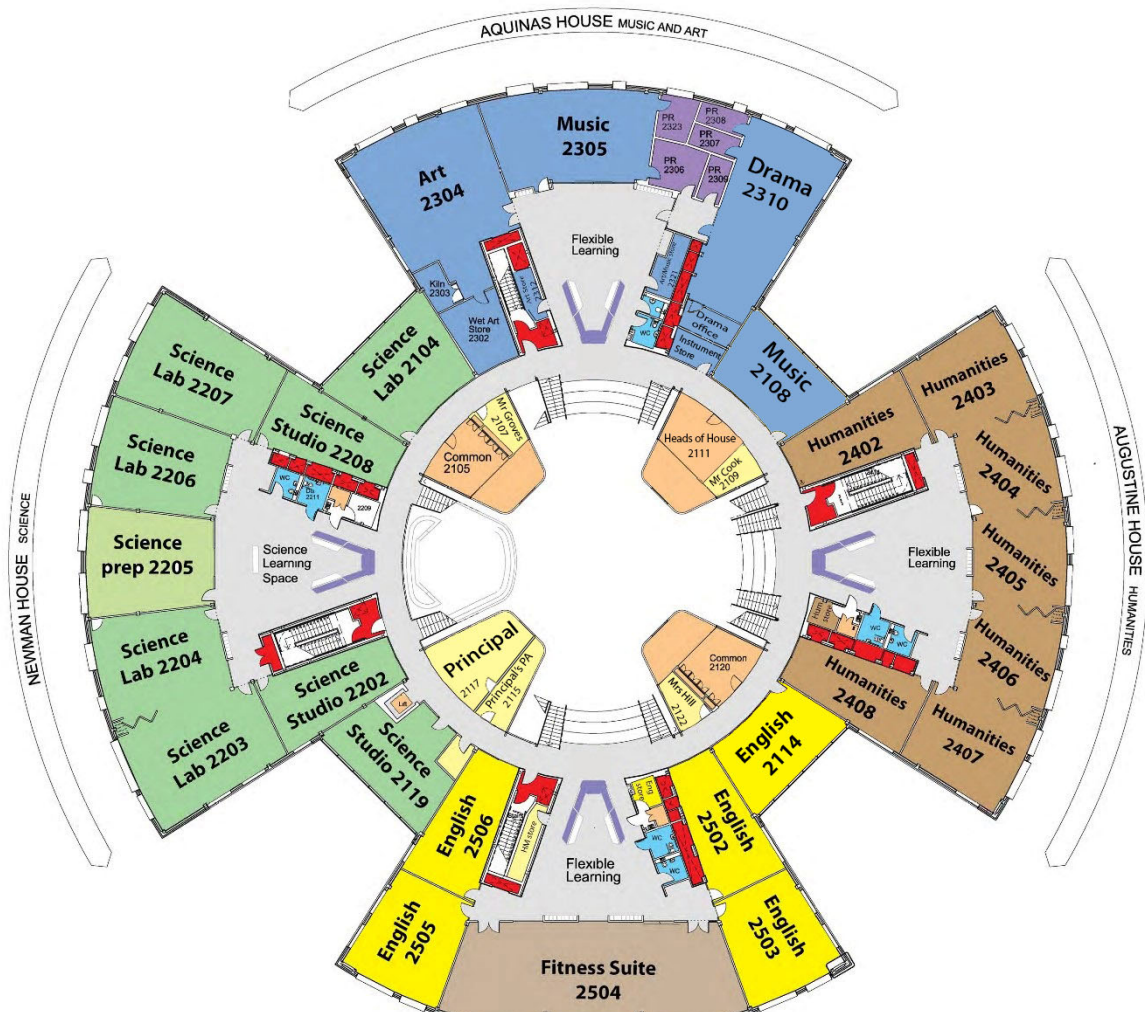

- **Biology 2206**
- **Physics 2207**
- **Chemistry 2204**
- **Psychology 2203**
- **English Lit 2503**
- **English Lang 2505**
- **Business 2402**
- **Geography 2406**
- **History 2403**
- **Politics 2404**
- **Art 2304**
- **Music 2305**
- **Sports Hall**
- **Fitness Suite**
- **Drama 2310**

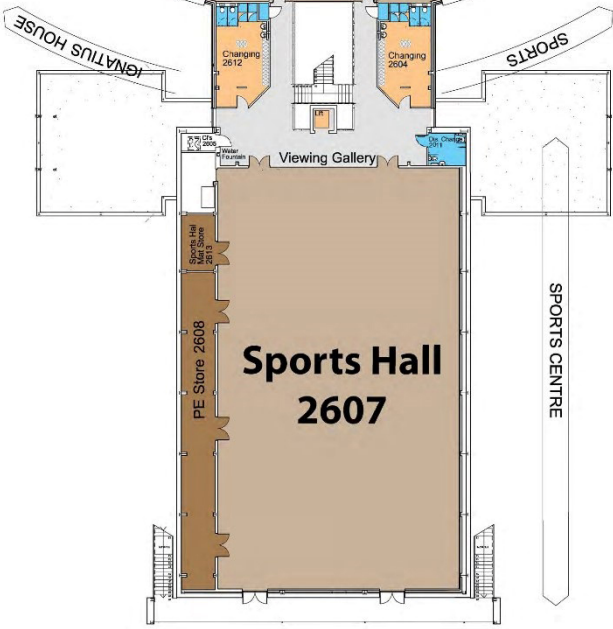

First Floor

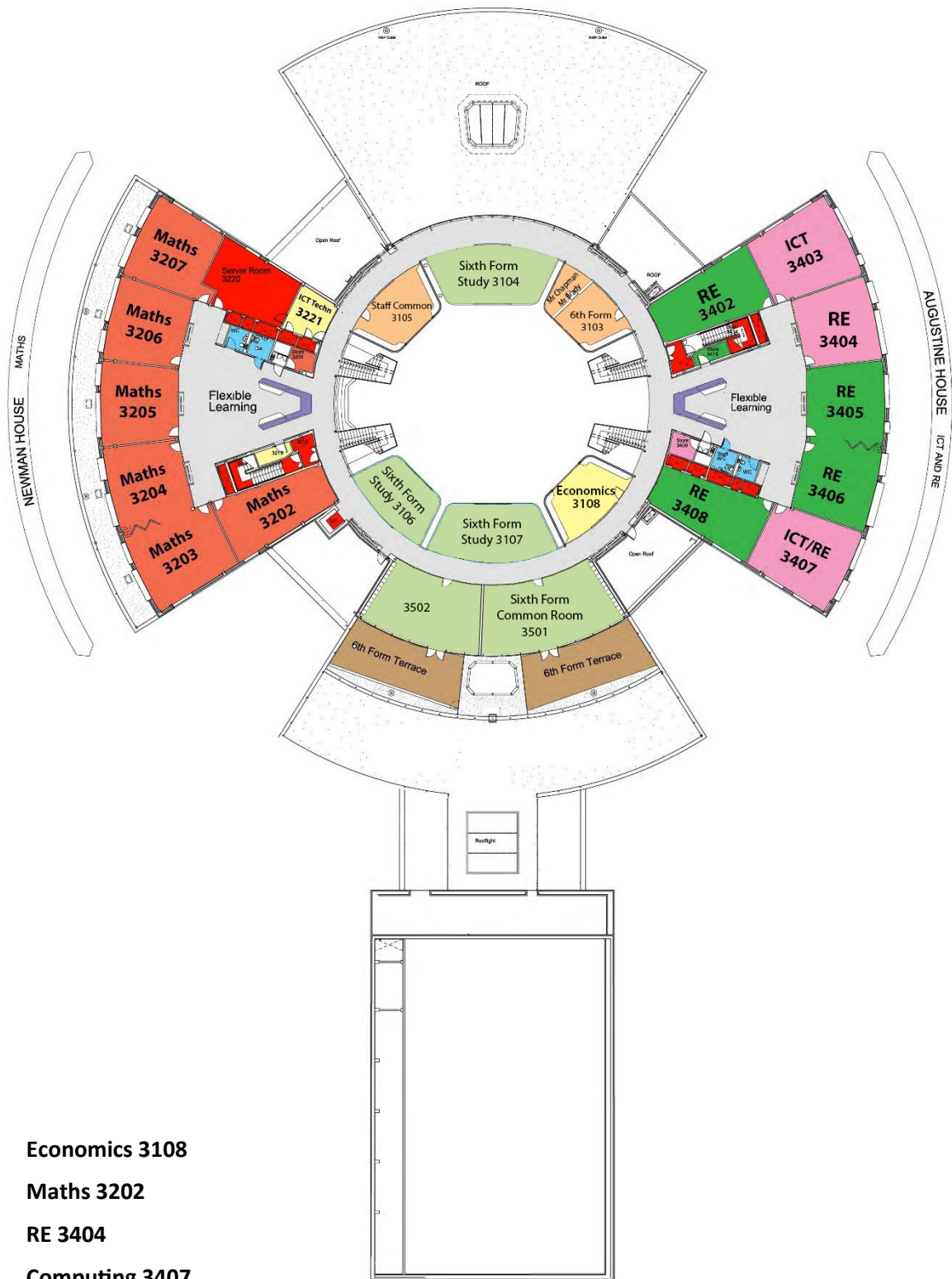

- Economics 3108
- Maths 3202
- RE 3404
- Computing 3407
- Sixth Form Common Room

Second Floor

Admission Criteria

Applicants who wish to study 3 A levels and a supplementary subject will require a minimum Attainment 8 Score of **60pts** to include at least a Grade 5 in Mathematics and English Language. A minimum of a Grade 6 is required in the subject to be studied at A level with the exception of Mathematics, Biology, Chemistry or Physics where a minimum of a Grade 7 is required. Applicants who wish to study Psychology must have a minimum of Grade 7 in either Biology, Chemistry or Physics. Applicants who wish to study Business or Economics, but have not had the opportunity to take a GCSE in that subject, must have at least a Grade 6 in Mathematics. Similarly any applicant who wishes to study Government and Politics must have at least a Grade 6 in English Language. Applicants who wish to study Computer Science must have also achieved a minimum Grade 7 in Mathematics.

Applicants who wish to study 4 A levels will require a minimum Attainment 8 Score of **75pts** to include at least a Grade 6 in Mathematics and English Language. A minimum of a Grade 6 is required in the subject to be studied at A level with the exception of Mathematics, Biology, Chemistry or Physics where a minimum of a Grade 7 is required. Applicants who wish to study Psychology must have a minimum of Grade 7 in either Biology, Chemistry or Physics. Applicants who wish to study Business or Economics, but have not had the opportunity to take a GCSE in that subject, must have at least a Grade 6 in Mathematics. Similarly any applicant who wishes to study Government and Politics must have at least a Grade 6 in English Language. Applicants who wish to study Computer Science must have also achieved a minimum Grade 7 in Mathematics.

Further Mathematics is only available to applicants who are taking 4 A Levels.

Applicants from the School

Eligible applicants from the School will be offered a Sixth Form place if they meet the entry criteria on GCSE Results Day.

External Applicants

After all applicants from Saint Ambrose College who have qualified for entry into the Sixth Form have been accommodated, any available places will be offered to students from other schools who have achieved the Sixth Form admissions criteria. If there are more successful applicants than places available then we will apply the Oversubscription Criteria.

Oversubscription Criteria

The criteria for over-subscription is overleaf and will only apply to external candidates. If in any category there are more applications than places available, priority will be given to those boys with the highest Attainment 8 score. Where more than one boy has the same score then priority in any category will be given to the boy living the closest distance from home to Saint Ambrose College. If distance is tied selection would take place by a random draw witnessed by all concerned parties.

Internal Applications

Internal applications will be online. The deadline for applications is Thursday 8th February 2024.

The link to the online form will be sent to the students school email account on the morning of 9th November.

External Applications

External applications will be online. The deadline for applications is Thursday 8th February 2024.

The online application form will be available from 9th November 2023 on the College website at: <https://www.st-ambrosecollege.org.uk/page/?title=Sixth+form+Admissions&pid=44>. References will be sought from their existing schools and students will be invited to attend a course discussion/interview. Admission to our Sixth Form is dependent on examination results, therefore confirmed offers will not be made until after the GCSE results are published. If the number of applicants who meet the admissions criteria exceed the number of places available, we will apply the oversubscription criteria.

Oversubscription Criteria (External Applicants only)

If the number of applicants achieving the required standard for entry exceeds the Published Admissions Number, then the following over-subscription criteria will apply in the following order to decide which pupils to admit.

1. Baptised Roman Catholic boys who are designated 'looked after children' or 'previously looked after children'.
2. Baptised Roman Catholic Boys who are in receipt of Pupil Premium whose home postcode falls within a nominated Local Pastoral Area. Details are provided in the list of Nominated Local Pastoral Areas.
3. Baptised Roman Catholic boys who have a brother attending the school.
4. Baptised Roman Catholic boys whose home postcode falls within a nominated Local Pastoral Area.
5. Baptised Roman Catholic Boys who are in receipt of Pupil Premium.
6. Other Baptised Roman Catholic boys.
7. Other Boys who are designated 'looked after children' or 'previously looked after children'.
8. Baptised Christian boys who have a brother attending the school.
9. Other boys who are in receipt of Pupil Premium.
10. Christian boys practising in other Christian denominations supported by a minister's reference confirming that they are a full and active member of the Church¹.
11. Other boys

If in any category there are more applications than places available, priority will be given to those boys with the highest Attainment 8 score. Where more than one boy has the same score in any category then priority will be given to the boy living the closest distance from the boy's home address² to St Ambrose College. If distance is tied selection would take place by a random draw witnessed by all concerned parties.

1. "Full and active" means a regular churchgoer who attends more than once a month, is known to the parish priest / minister and is involved in church activities.

2. "Home address" means the address where the child normally and permanently lives on a full-time basis, not the address of any child-minder, grandparent or any other relative. In the case of parents who are separated, the application will also be considered from the address where the child lives, even though the child may regularly spend some time at another address. Where it is claimed that the child's residency is shared equally between two addresses parents may decide which address will be used for the purpose of the application.

Nominated Local Pastoral Areas

Saint Ambrose Deanery

(Diocese of Shrewsbury)

The following Local Pastoral Areas include the following postcodes: All WA14, WA15, M31 and M33 postcodes.

St. Hugh and St John

West Timperley

St. Vincent de Paul's

Altrincham

All Saints

Ashton-on-Mersey

St. Margaret Ward

Sale

St. Joseph's

Sale

Holy Angels

Hale Barns

Our Lady of Lourdes

Partington

Holy Family

Sale Moor

2. Saint Ambrose Barlow Deanery

(Diocese of Salford)

The following Local Pastoral Areas include the following postcodes: All M16, M21, M32 and M41 postcodes.

Our Lady's & St. Alphonsus

Moss Side/Old Trafford

St. Ann's & St. Hugh of Lincoln

Stretford

Our Lady and the English Martyrs'

Davyhulme/Urmston

St. Monica's

Flixton

St. John's and St Teresa's

Firswood / Chorlton

Saint Ambrose College

Notes: